

CL60 Pusher Series D

Series D Serial Numbers-1980111203U06 and up. 2- Speed,
220 Volt, 3 Phase, 60Hz.
Use Series-D Plates.



Click on Red Dot
OR
Call us
800-465-6060

CLICK HERE FOR
DISCS

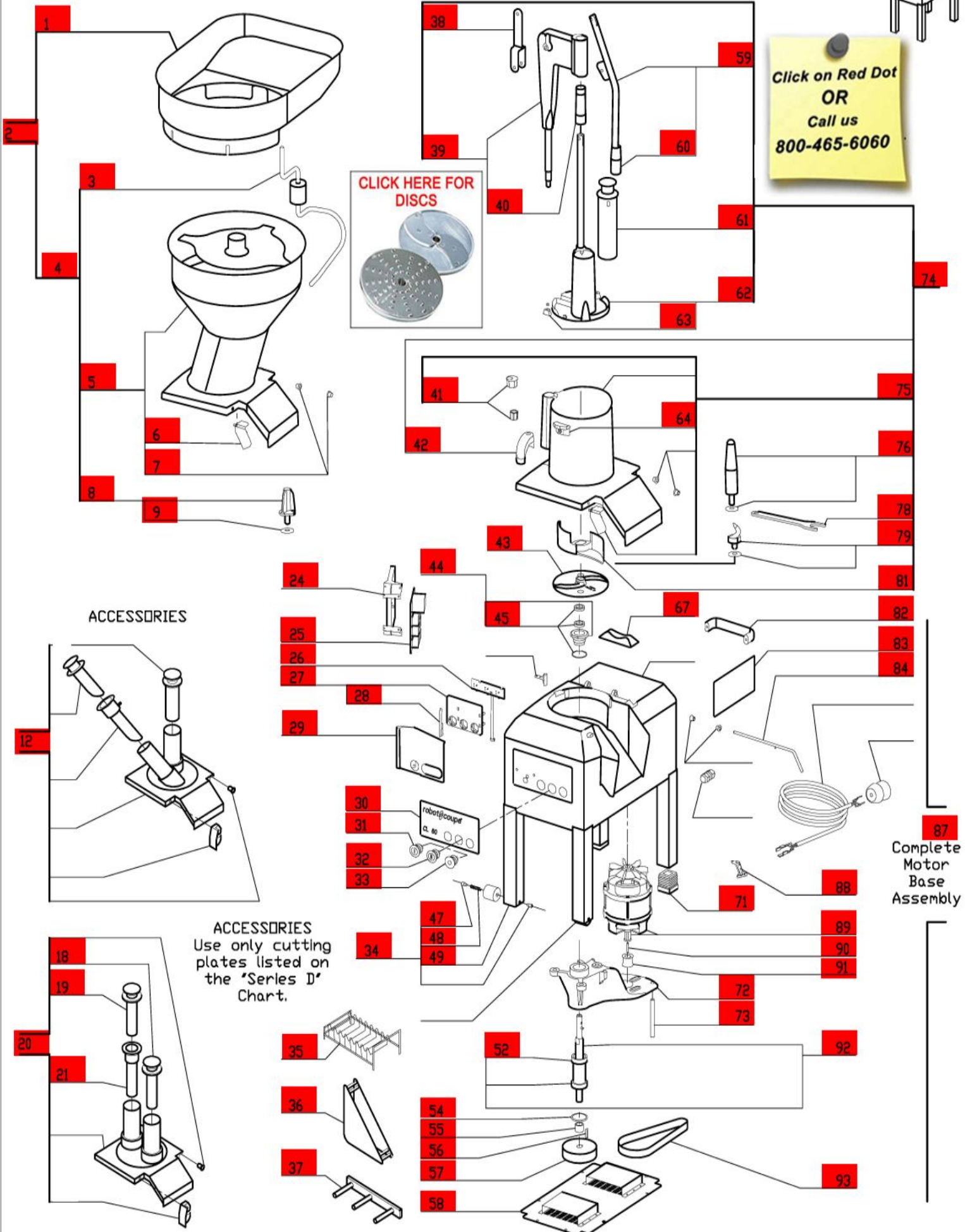

ACCESSORIES
Use only cutting
plates listed on
the "Series D"
Chart.

87
Complete
Motor
Base
Assembly